



1806/8 Kavanagh Street Southbank, VIC



2



2



2

UNDER CONTRACT

Nested on level 18 of the Award-winning Triptych, well known by its eco-credentials, unique 'vertical village' concept and distinction as an external artwork by famed designer, Robert Owen. This modern and spacious (171sqm of living) apartment home will truly impress you with grand entrances, nine-metre-high beautiful glass atrium with a live green living wall at your door. The emphasis on high finish throughout will attract your full attention from the first moment.

Surrounded by the Melbourne Recital Centre, Melbourne Symphony Orchestra, the Arts Centre and backdrop to the National Gallery of Victoria, Federation Square, the Australian Centre for Contemporary Art (ACCA), Malthouse and more, Triptych has much to live up to. Driving within 10 mins, the location is well covered by prestigious schools of Mac Roberson Girl School, Melbourne Grammar, Wesley College and University of Melbourne Southbank Campus etc..

Lina Wang

0450 026 669

Yi Zeng

0452 667 881

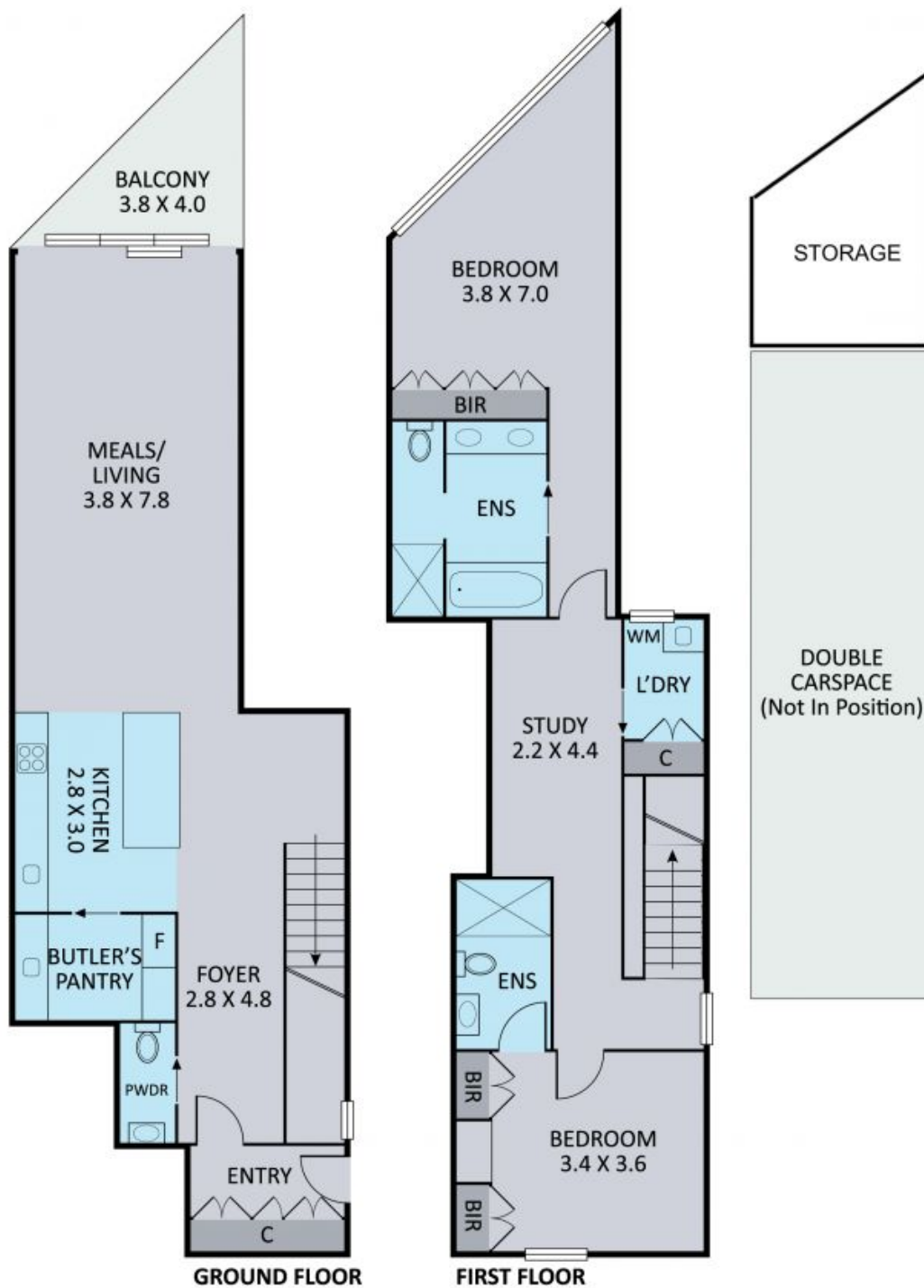

1806/8 Kavanagh Street

Southbank, VIC

